

Galveston County Food Bank (GCFB)

INVITATION TO BID (Pantry Mini-Split Project)

Vendor Name: _____

ITBNo.: 2202-03-ARPA-ENV-HVAC

Address: _____

Submittal Deadline: 5-1-2022

Phone: _____

Contact Information

Buyer: Donnie VanAckeren

Fax #: _____

Phone No: (409)945-4232

E-mail: Donnie@GALVESTONCOUNTYFOODBANK.org

Authorized Signature: _____

Printed Signature: _____

Date: _____

THIS ITB IS A SOLICITATION FOR BID AND IS NOT A CONTRACT OR AN OFFER TO CONTRACT.

1.0 Bid Instructions and Award Process

1.1 This Invitation to Bid (ITB) **must be completed, signed and returned with your bid** for the items/products listed per **Attachment 1 – Specifications/Scope of Work and Price Schedule**. Failure to sign and return this form and a completed Price Schedule and adherence to all requirements directed herein will be a basis for disqualification.

1.2 One (1) paper copy of the Bid or one (1) electronic version must be submitted and received in the GCFB Office or before the date specified above and delivered, or e-mailed to:

Mailing Address: Galveston County Food Bank
624 Fourth Avenue North
Texas City, Texas 77590

Fax Number: (409) 945-2563

E-mail: Donnie@GALVESTONCOUNTYFOODBANK.org

The Galveston County Food Bank
624 4th Ave N
Texas City, TX 77590
Phone (409) 945-4232
Website <http://www.galvestoncountyfoodbank.org>

USDA Nondiscrimination Statement

In accordance with Federal civil rights law and U.S. Department of Agriculture (USDA) civil rights regulations and policies, the USDA, its Agencies, offices, and employees, and institutions participating in or administering USDA programs are prohibited from discriminating based on race, color, national origin, sex, disability, age, or reprisal or retaliation for prior civil rights activity in any program or activity conducted or funded by USDA.

Persons with disabilities who require alternative means of communication for program information (e.g. Braille, large print, audiotape, American Sign Language, etc.), should contact the Agency (State or local) where they applied for benefits. Individuals who are deaf, hard of hearing or have speech disabilities may contact USDA through the Federal Relay Service at (800) 877-8339. Additionally, program information may be made available in languages other than English.

To file a program complaint of discrimination, complete the [USDA Program Discrimination Complaint Form](http://www.ascr.usda.gov/complaint_filing_cust.html), (AD-3027) found online at: http://www.ascr.usda.gov/complaint_filing_cust.html, and at any USDA office, or write a letter addressed to USDA and provide in the letter all of the information requested in the form. To request a copy of the complaint form, call (866) 632-9992. Submit your completed form or letter to USDA by:

- (1) mail: U.S. Department of Agriculture
Office of the Assistant Secretary for Civil Rights
1400 Independence Avenue, SW
Washington, D.C. 20250-9410;
- (2) fax: (202) 690-7442; or
- (3) email: program.intake@usda.gov.

This institution is an equal opportunity provider.

2.0 Bidder's Affirmations

By signature hereon, Bidder represents and warrants the following:

- A. Bidder acknowledges and agrees that (1) this ITB is a solicitation for a bid and is not a contract or an offer to contract; (2) the submission of a bid by Bidder in response to this ITB will not create a contract between GCFB and Bidder; (3) GCFB has made no representation or warranty, written or oral, that one or more contracts with GCFB will be awarded under this ITB; and (4) Bidder will bear, as its sole risk and responsibility, any cost arising from Bidder's preparation of a response to this ITB.
- B. Bidder is a reputable company that is lawfully and regularly engaged in providing products and/or performing the services.
- C. Bidder has the necessary experience, knowledge, abilities, skills, and resources to provide the products and/or perform the services.
- D. Bidder understands (i) the requirements and specifications set forth in this ITB and the terms and conditions set forth under which Bidder will be required to operate.

- E. If selected by GCFB, Bidder will maintain any insurance coverage as required by the order and/or contract during the term thereof.
- F. All statements, information and representations prepared and submitted in response to this ITB are current, complete, true and accurate. Bidder acknowledges that GCFB will rely on such statements, information and representations in selecting the successful Bidder. If selected by GCFB, Bidder will notify GCFB immediately of any material change in any matters with regard to which Bidder has made a statement or representation or provided information.
- G. Bidder offers and agrees to provide the products and/or furnish the services to GCFB and comply with all terms, conditions, requirements and specifications set forth in this ITB.
- H. Bidder certifies that the individual signing this document and the documents made a part of this ITB is authorized to sign such documents on behalf of Bidder and to bind Bidder under any agreements and other contractual arrangements that may result from the submission of Bidder's bid.
- I. Bidder certifies its compliance with all federal laws and regulations pertaining to Equal Employment Opportunities and Affirmative Action.
- J. Bidder confirms that neither Bidder nor its Principals are suspended, debarred, proposed for debarment, declared ineligible.

3.0 Payment Terms

GCFB's payment terms are upon completion of work.

- 4.0 Proposal Acceptance Proposals shall be open to acceptance by GCFB until: The successful firm has entered into a contract with GCFB for performance of the Work This Request for Proposal should not be construed as an agreement to purchase goods or services.

ATTACHMENT 1
SPECIFICATION/SCOPE OF WORK AND PRICE SCHEDULE
ITB NO: 2202-03-ARPA-ENV-HVAC

1.0 Specifications/SOW

1. The Galveston County Food Bank (GCFB) is requesting bids to replace the 2 existing Mini-Split package units located in the Client Choice Food Pantry (Pantry). The GCFB pantry is located at 213 6th St N in Texas City. (see attached diagram and specification sheet)
2. Existing electrical lines to be used if feasible.
3. Identify brand and specifications of proposed replacement Mini-Split package unit(s) you recommend and reason for substitute brand.
4. Ensure that condensate lines and condensate pumps are replaced and connected.
5. Provide own ladders for removal and installation of Mini-Split evaporator and condensation units
6. Provide all materials and labor to complete the project.
7. Measurements, sizing and electrical needs of units to be verified by contractor.
8. Work to be completed and coordinated with Pantry manager as pantry operations will be in progress during installation.
9. The work includes labor, equipment and all operations required for resurfacing areas as indicated on attached.
10. Obtain necessary Texas City permits
11. Please provide 3 references
12. Develop project timetable.
13. If selected to do work, provide certificate of insurance
14. If qualified, please provide evidence of any of the following: HUBs, Minority (MBE), Women-owned (WBE), Disadvantaged (DBE), Persons with Disabilities (PDBE), Veteran (VBE), Service Disabled Veteran (SDVBE) or Small (SBE) Business Enterprises.

Submitted by:

Company Name

Authorized Signature

Date

Printed Name and Title

HIGH WALL DUCT-FREE • MINI-SPLIT STANDARD SINGLE ZONE • INVERTER

24,000 BTUs

- LS246HV (HP Model)
- 24,000 BTUs Cooling
- 26,000 BTUs Heating

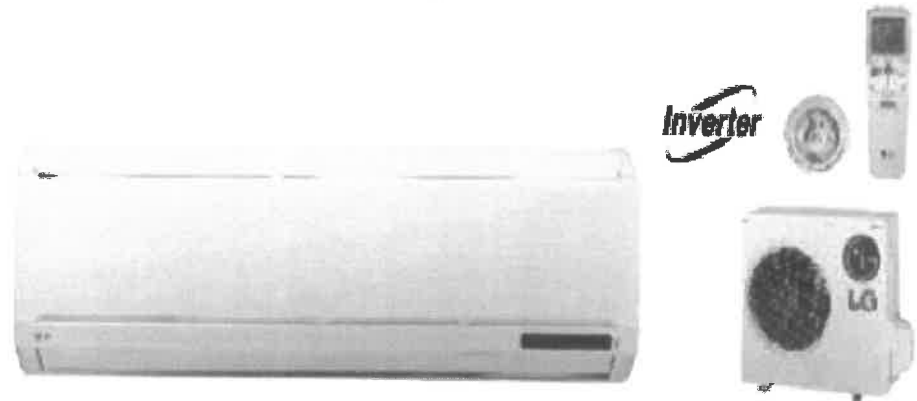

- | | | | | |
|---|---|--|--|---|
| <ul style="list-style-type: none"> • Inverter (variable speed compressor) • R-410A Refrigerant • Gold Fin™ Anti-Corrosion • Chaos Swing • Self-cleaning indoor coil • Auto changeover • Jet Cool • Cooling/Heating/Fan Mode • Auto sleep mode • Ultra-quiet operation | <ul style="list-style-type: none"> • Dehumidifying mode • Auto restart • 24-Hour on/off timer • Built-in low ambient standard, down to 14°F (cooling mode) • Manual power switch • Defrost control • Temperature display on indoor unit • Evaporator frost control • Energy Saving | <ul style="list-style-type: none"> • 4 Fan speeds | <p>Interior Unit Includes:</p> <ul style="list-style-type: none"> • Wall unit • Installation plate & hardware • Remote control, batteries, holder & holder hardware • Installation manual | <p>Exterior Unit Includes:</p> <ul style="list-style-type: none"> • Exterior unit • Exterior unit has sufficient refrigerant for charging indoor coil and a 25' line set (line set not included) <p>ETL# : 3091879</p> |
|---|---|--|--|---|

System Model #	LS246HV
Indoor Model #	LSN246HV
Outdoor Model #	LSU246HV
Performance	
Capacity (BTUs)	● 24,400 ● 26,000
SEER	14.7
Air Circulation (CFM H/M/L)	530/450/370
Fan Speeds	4/Auto/Chaos
Dehumidification (pts/hr)	6.6
Indoor dB(A)*	47/42/39
Outdoor dB(A)*	56
Electrical	
Rated Voltage Outdoor	230/208-60-1
Rated Voltage Indoor	230/208-60-1
Indoor Dimensions	
W x H x D (Inches)	42 15/16 x 11 13/16 x 7 1/32
Weight (lbs.)	28.6
Outdoor Dimensions	34 5/16 x

GALVESTON COUNTY FOOD BANK
624 4TH AVENUE NORTH
TEXAS CITY, TX

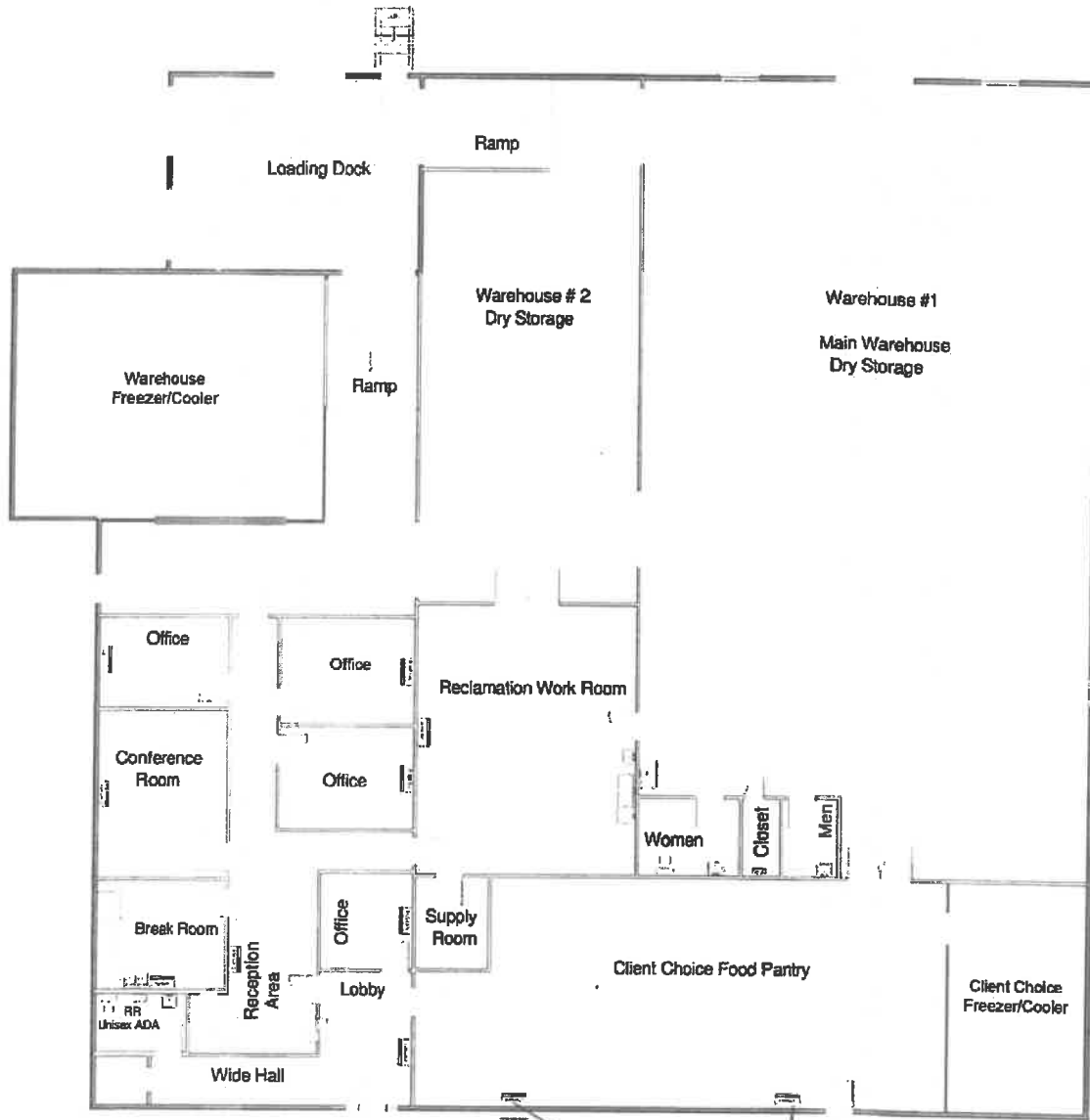

624 4TH AVENUE NORTH

INDEPENDENT
MINI-SPLITS